

HALF BALLROOM STANDARD DIAGRAMS

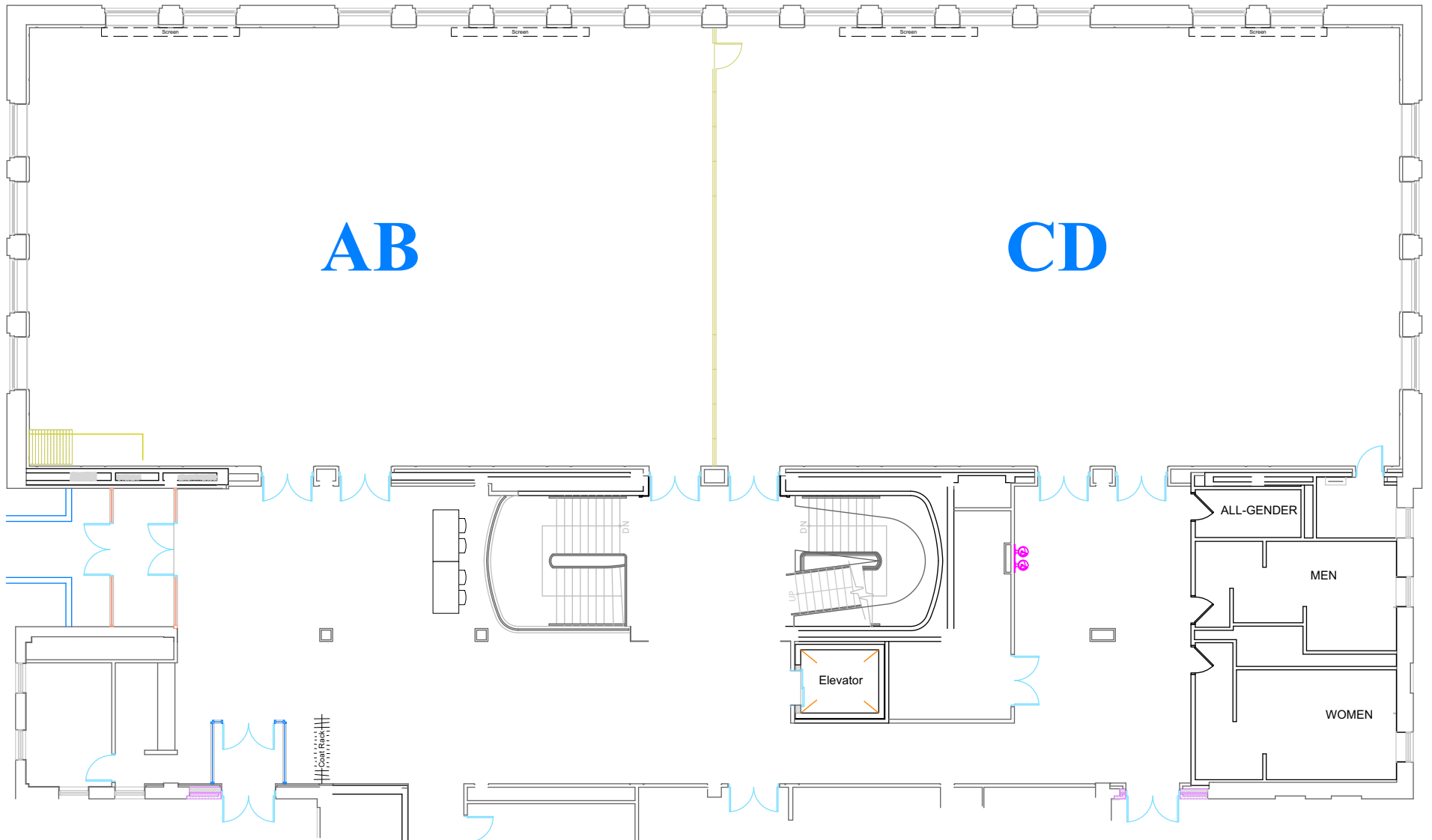

Please note that Ballrooms "AB" and "CD" are smaller in width (79ft) than "BC" (89ft).
"BC" setups will not fit in "AB" or "CD" partitions.

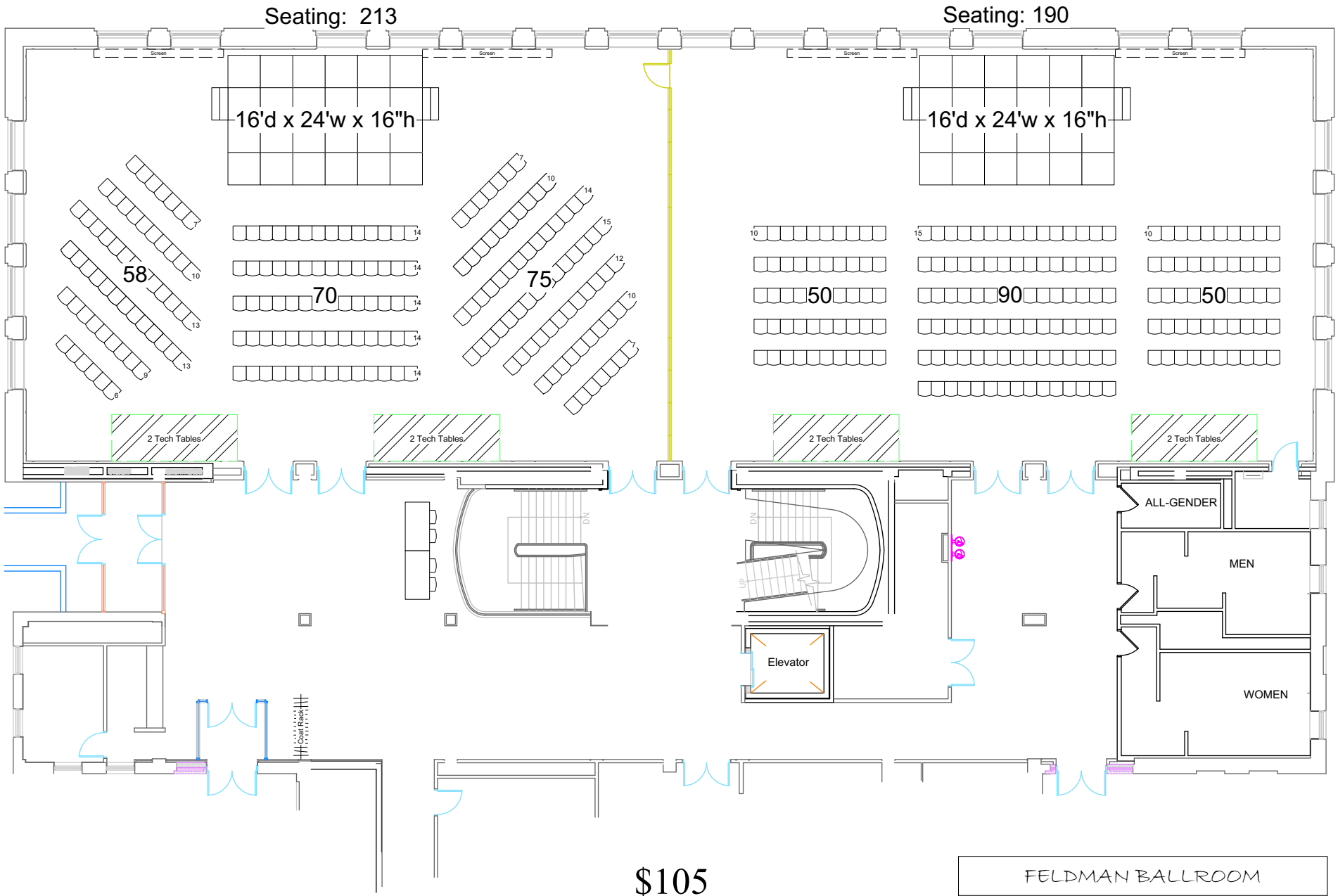

\$105

FELDMAN BALLROOM
AB/CD Show w/ Auditorium Seating
Event Date: XX/XX/XXXX
Drafted By:

Seating for 128

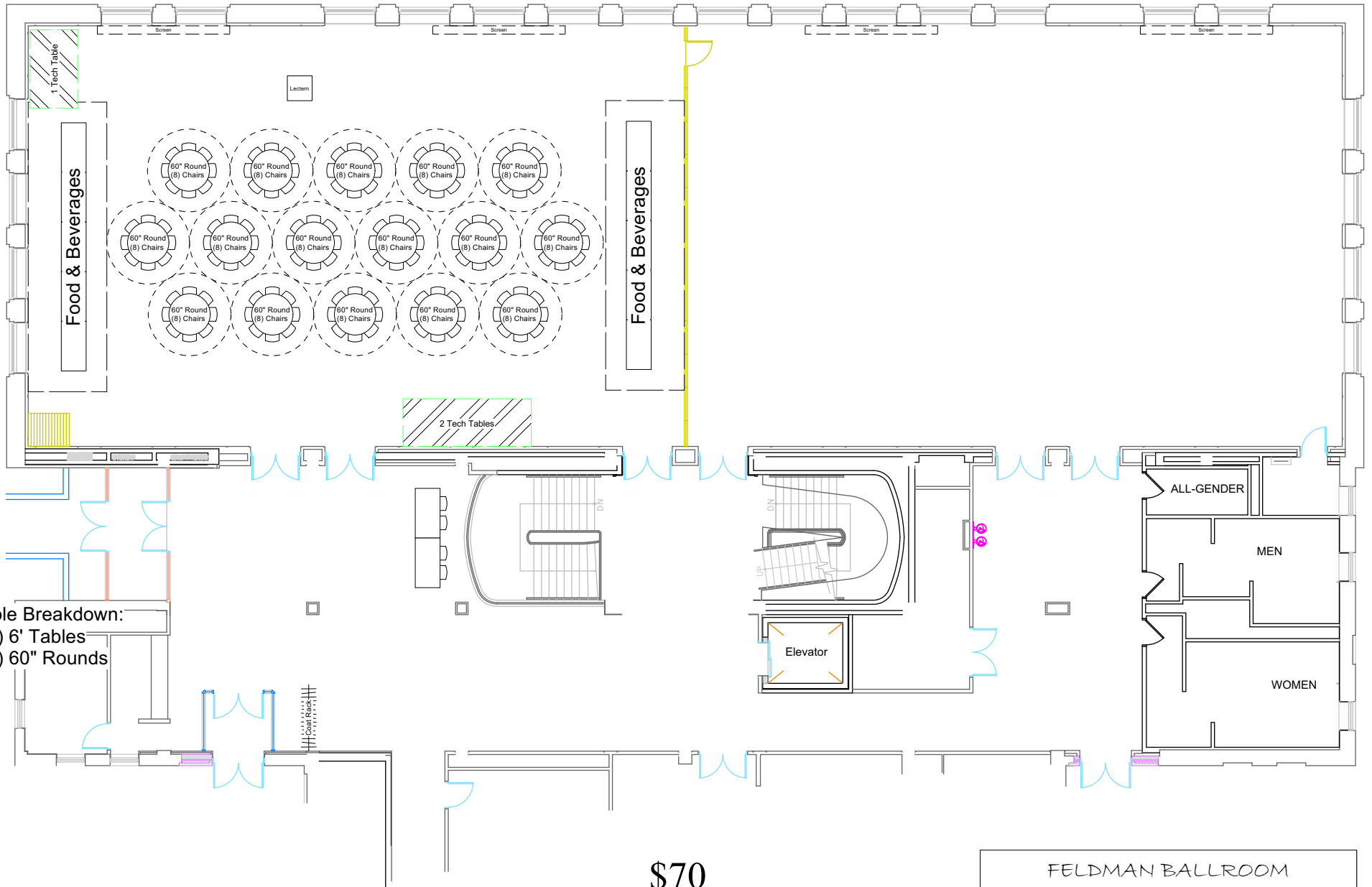
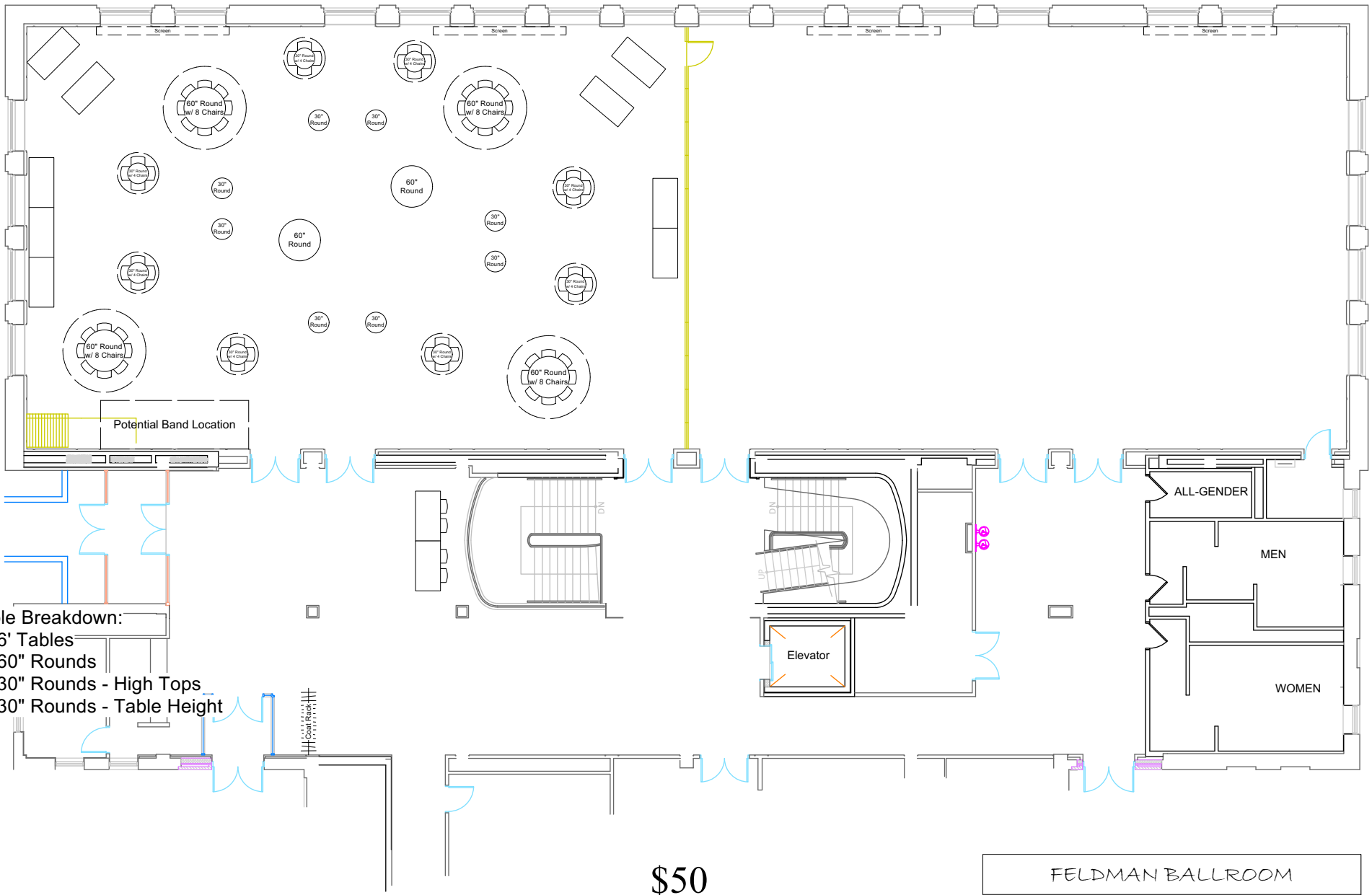

Table Breakdown:
 (10) 6' Tables
 (16) 60" Rounds

\$70

FELDMAN BALLROOM
AB/CD Banquet
Event Date: XX/XX/XXXX
Drafted By:



- Table Breakdown:
- (9) 6' Tables
 - (6) 60" Rounds
 - (8) 30" Rounds - High Tops
 - (8) 30" Rounds - Table Height

\$50

FELDMAN BALLROOM
AB/CD Reception
Event Date: XX/XX/XXXX
Drafted By:

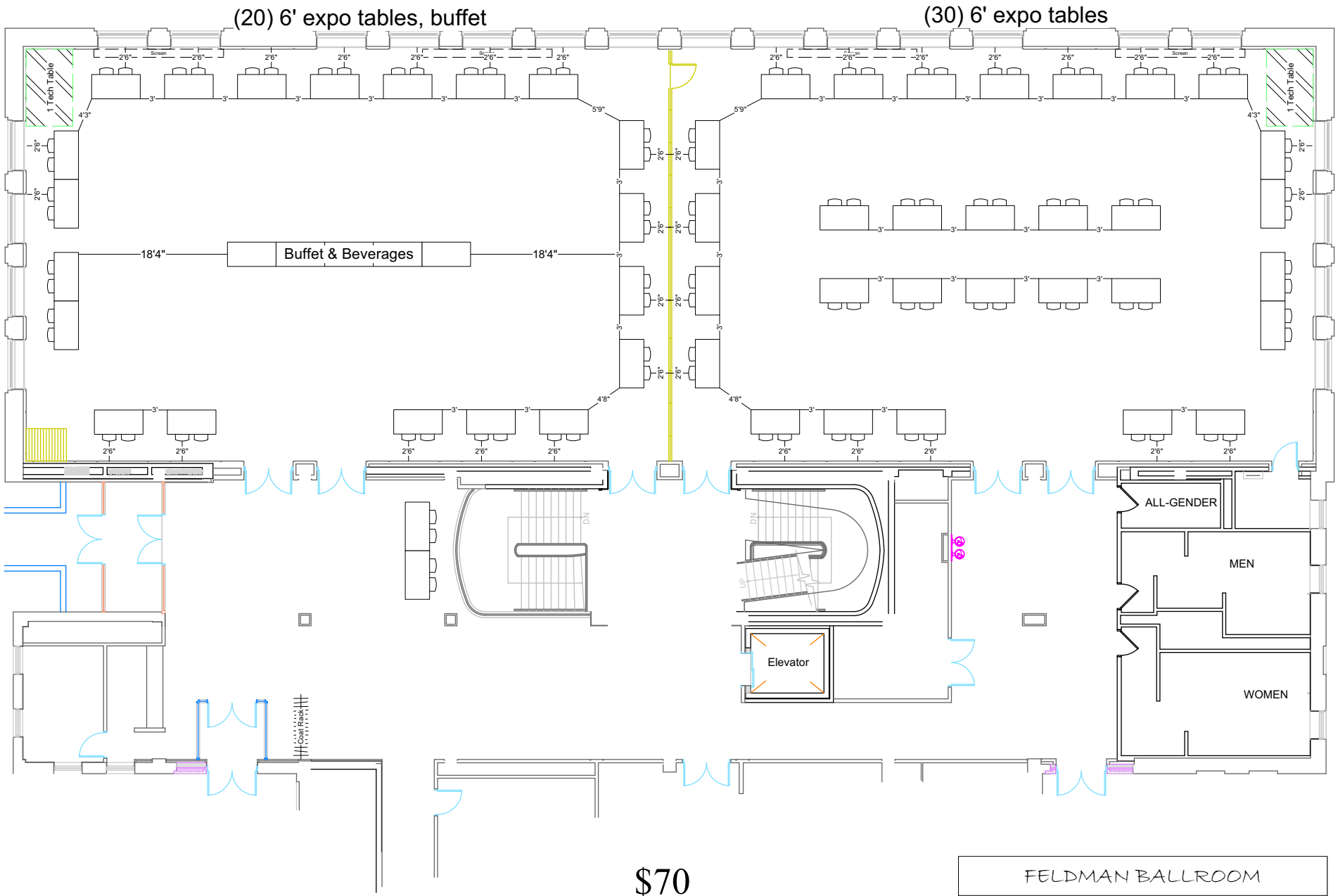

\$70

FELDMAN BALLROOM
AB/CD Expo
Event Date: XX/XX/XXXX
Drafted By:

Classroom for 80 People

*Same Setup for BC

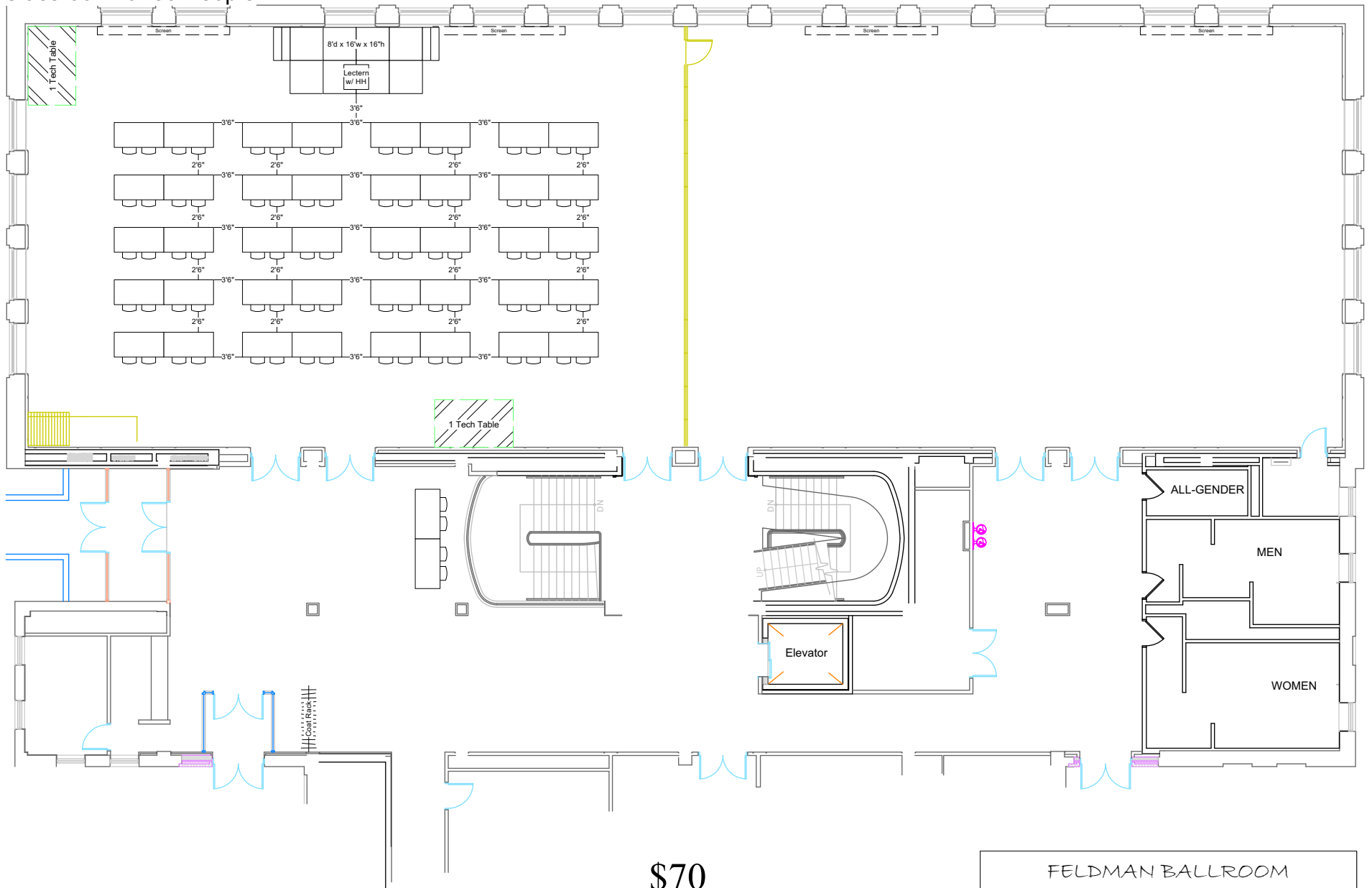

\$70

FELDMAN BALLROOM
AB/CD [BC] Classroom
Event Date: XX/XX/XXXX
Drafted By:

Audience Seating for 210

Audience Seating for 245

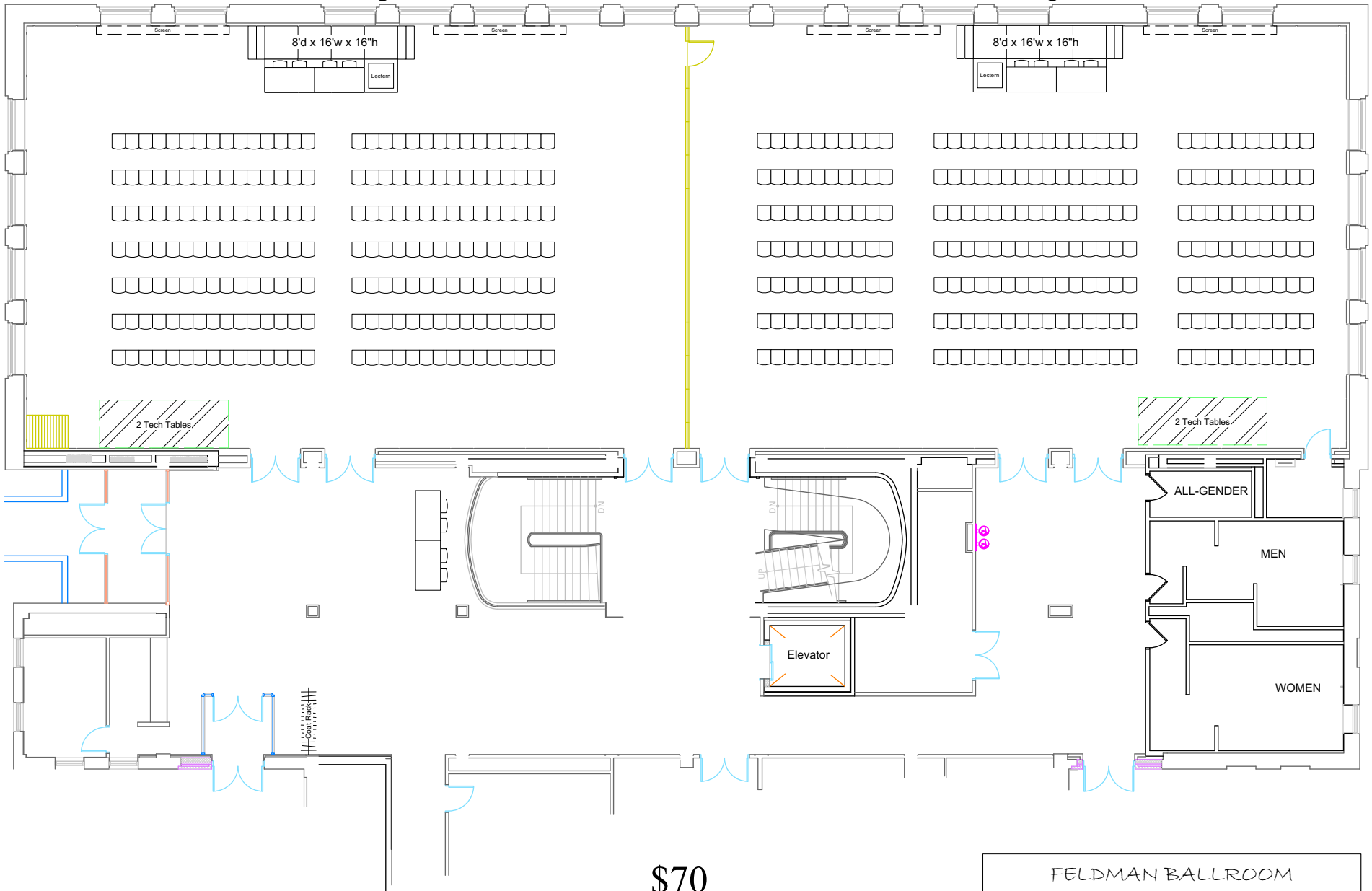

\$70

FELDMAN BALLROOM
AB/CD Lecture
Event Date: XX/XX/XXXX
Drafted By: