

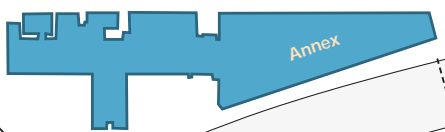

TO MT. HOPE AVENUE ➔

ELMWOOD AVENUE

School of Medicine and Dentistry (Ground Floor)



KENDRICK ROAD

Visitor Parking P

Kornberg Medical Research Building

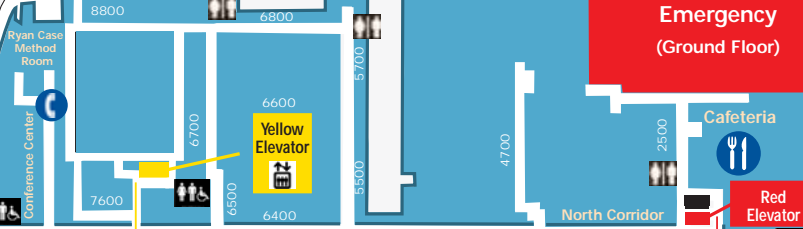

Emergency (Ground Floor)

THOMAS H. JACKSON DRIVE

Lobby Information Desk



Visitor Parking Garage P

Garage Elevators

Silver Elevator

Ambulatory Care Facility

Strong Behavioral Health

Blue Elevator

(Strong Behavioral Health Entrance from Visitor Parking on Ground Floor)

Chapel

Miner Library

Orange Elevator

Green Elevator

Family Waiting Room

Bus Loop

James P. Wilmot Cancer Center

EAST DRIVE

CRITTENDEN BOULEVARD

TO MT. HOPE AVENUE ➔

Visitor Parking P

Helen Wood Hall School of Nursing

Future site of Clinical and Translational Science Institute

Eye Institute (Entrance and Parking on Ground Floor)

1st Floor

- ELEVATOR
- INFORMATION
- PARKING
- PAY TELEPHONES
- RESTROOMS

