



# UR Student Demo Days

*May 2018*

---



# Chatting for Zoom Participants

---

For those joining the Zoom:

- 1) Please access the **Chat** feature at the bottom of your screen
- 2) Please chat directly with Cindy Fronterre (She will then pose questions on your behalf)
- 3) Select Cindy Fronterre in the drop down menu in the chat window (do not select “everyone”)

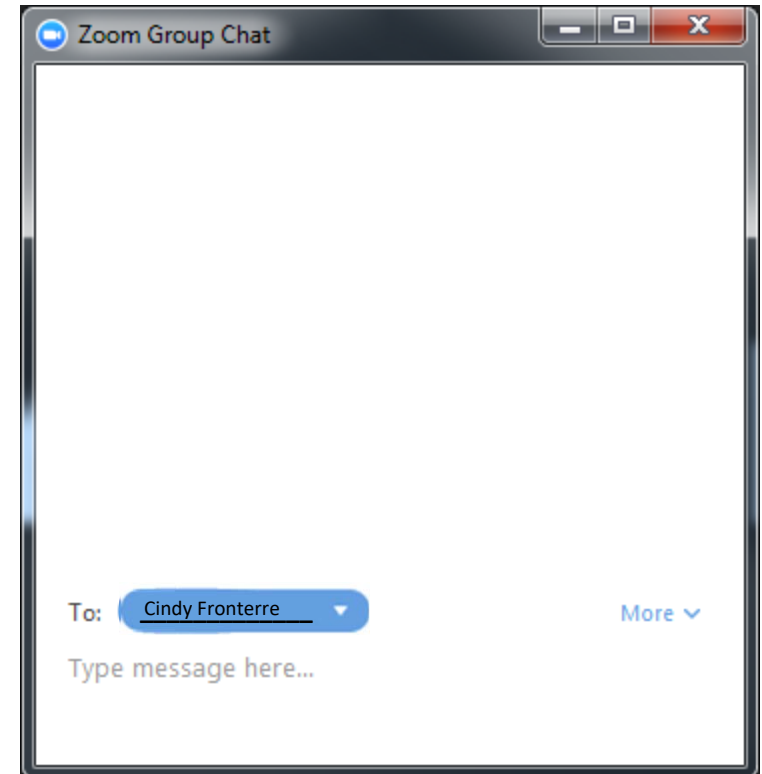

# Agenda

---

▶ Student On-Boarding Demonstration

▶ Q&A

▶ Wrap up

# UR Student Live Demonstration

---

- <https://wd5-impl.workday.com/wday/authgwy/rochester4/login.html>
  
- **Appendix Includes:**
  - Terminology
  - Timeline
  - Special Interest Groups (SIG)
  - UR Student Communications and website
  - UR Student Screen Navigation

# Next Steps

---

- 5 minute survey sent to all May Demo Days registrants
- Next Demo Days June 19/20
  - **Agenda:** Registration within UR Student
  - **Recommended Attendance:** Faculty and Staff
  - Details to come in UR Student News



UNIVERSITY *of* ROCHESTER



UR Student

# Appendix

---

# UR Student Terminology

---

- **Academic Level Refers to Division.**
  - This includes division 1, 2 or 3 in SIS (UG, Grad, Med). There are many more levels in UR Student to assist with administration of programs
- **Academic Periods**
  - Refers to Term/Semester/Quarter. These are dynamic dates
- **Academic Units**
  - Refers to Schools/Colleges/Departments
- **Cohorts**
  - Used any time a student has to be attached to an advisor and to group students by attributes for which there is not a field in WD
- **Credential**
  - Degree
- **Dashboard**
  - A collection of reports tailored to the user or role
- **Eligibility Rules**
  - System based guardrails to enforce policies
- **Enrollment**
  - Registration
- **Faceted Search**
  - A search where the end user has the ability to identify particular criteria for a population .
- **Onboarding**
  - A targeted communications for new and returning students to ensure that tasks and other necessary documentation is completed (FERPA, Financial Responsibility Agreement, etc.)
- **Programs of Study**
  - Includes Certificates, Majors, Minors, Cluster
- **Tenant**
  - An instance or system environment of UR Student (Workday) where project design and testing work is done. There are several tenants the project team uses for Conversions, Configuration, Integrations. etc.. This will combine into a production build for go live.

UR STUDENT



# UR Student Interface Terminology

---

- **Home (University of Rochester Logo)**
  - Will always navigate you back to the landing page
- **Inbox (Envelope)**
  - Contains all activity that is required of you
- **Notifications (Bell)**
  - Displays notifications regarding business processes and rule-based alerts
- **Profile Page (Cloud or Your Photo)**
  - Opens all sections available from the Home page. You can configure your personal setting here as well.
- **Ellipses (Twinkie, Related Action)**
  - Displays the related actions menu for an object (available only if the user has permission to perform additional actions on that object)
- **Search Bar (Magnifying Glass)**
  - Can type three letters of a given word (or the whole word) to receive a response from the system
- **Applications (Picture Icons in the middle of the page)**
  - Workday calls these widgets and they can take you to functional areas, reports, or dashboards
- **Categories (within the search function)**
  - Are the different areas within Workday such as Banking, Payroll, People, Reporting, Student, etc.
- **Student Profile**
  - Includes the student's personal information, registration, billing, financial aid, contact information, etc. in one convenient place
- **Functional Areas**
  - Tabs on the student profile for Academics, Student Financials, Financial Aid, etc.
- **Workday App (for Mobile)**
  - Can be downloaded from the App Store to use on a Droid, iPhone, or iPad

# Prepare for UR Student Changes

The UR Student implementation will affect all Faculty, Students and related Staff

- Project Website (<http://www.rochester.edu/urstudent/>)
  - News – Stay in the know on project announcements and system demonstrations, Subscribe for updates
  - Subscribe to receive up to the minute news

The screenshot displays the UR Student website interface. At the top, a navigation menu includes 'UR Student', 'News' (highlighted with a red box), 'SIG', 'Faculty', 'Staff', 'Students', 'FAQ', 'Calendar', and 'Contact'. Below the navigation is the 'UR Student' title and a brief introductory paragraph. A 'Welcome to UR Student!' section follows, with a paragraph explaining the system's purpose. On the left side, there is a 'UR Student' logo with a 'Subscribe' button and a form labeled 'Subscribe to get updates!' containing an 'E-Mail' input field (highlighted with a red box) and a 'Subscribe' button. Below this is a 'GLOSSARY SEARCH' section powered by 'Data Cookbook', featuring a search input field, an 'Exact match?' checkbox, and a 'Search' button. At the bottom of the page, there is a banner image of a university campus with a 'Welcome' message overlay.

# Program Overview – Phase 1 Timeline

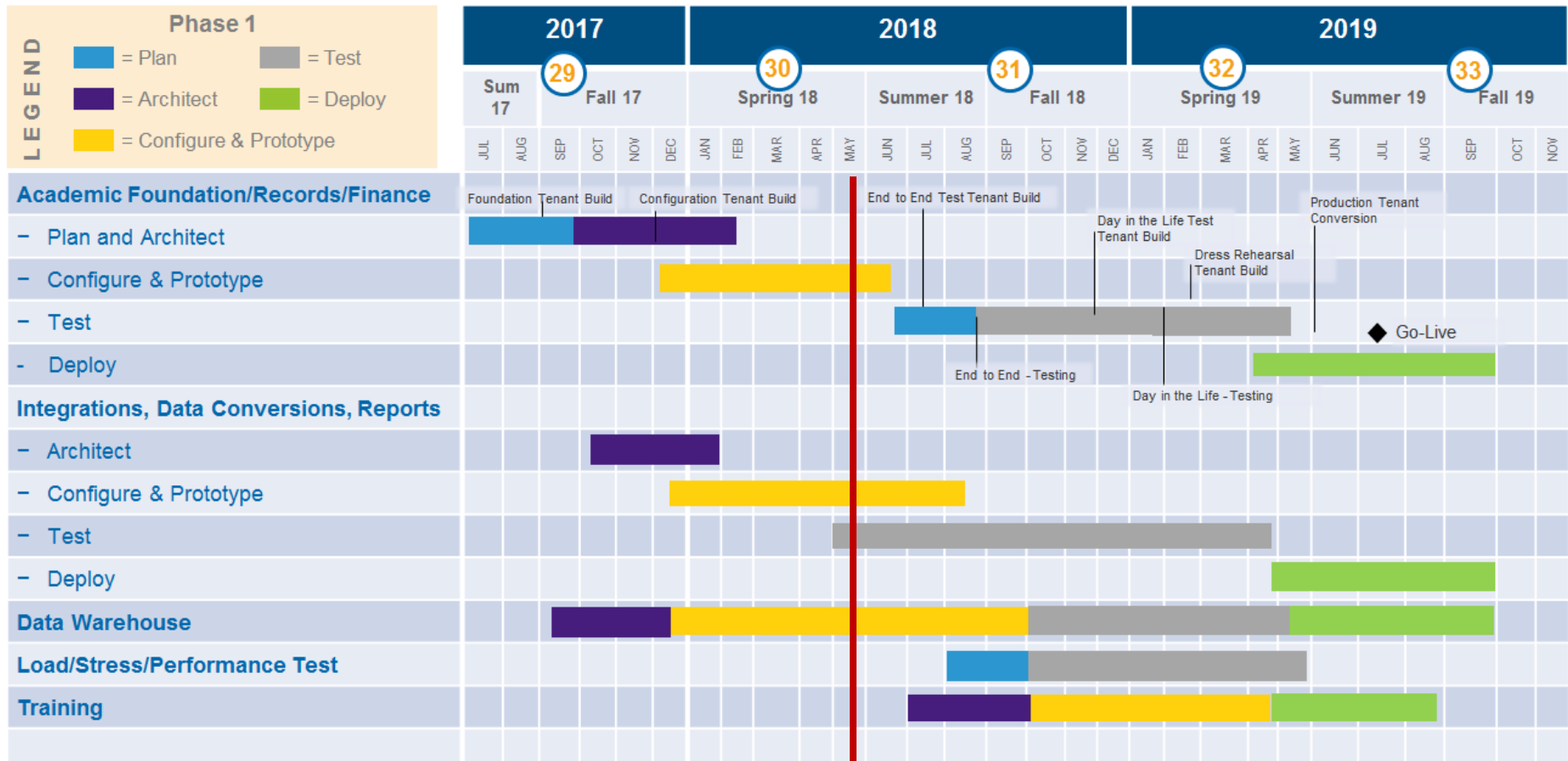

We are here

# University Involvement

---

The project team includes membership from all schools with our Special Interest Groups (SIGs). Participation of SIG members is integral to the success of the program; membership is intended to be part-time.

SIG Members Contributions to include:

- Input into common business practices
- Input into system configuration
- Business requirements' definition
- Identification of necessary data for conversion
- Validation of converted data
- Creation of test cases
- Execution of user testing
- Serving as a project champion

Advising SIG

Faculty SIG

Student Records &  
Registration SIG

Student Finance SIG

Institutional Research  
& Reporting SIG

Information  
Technology SIG

# UR Student System

---

# UR Student - Landing Page

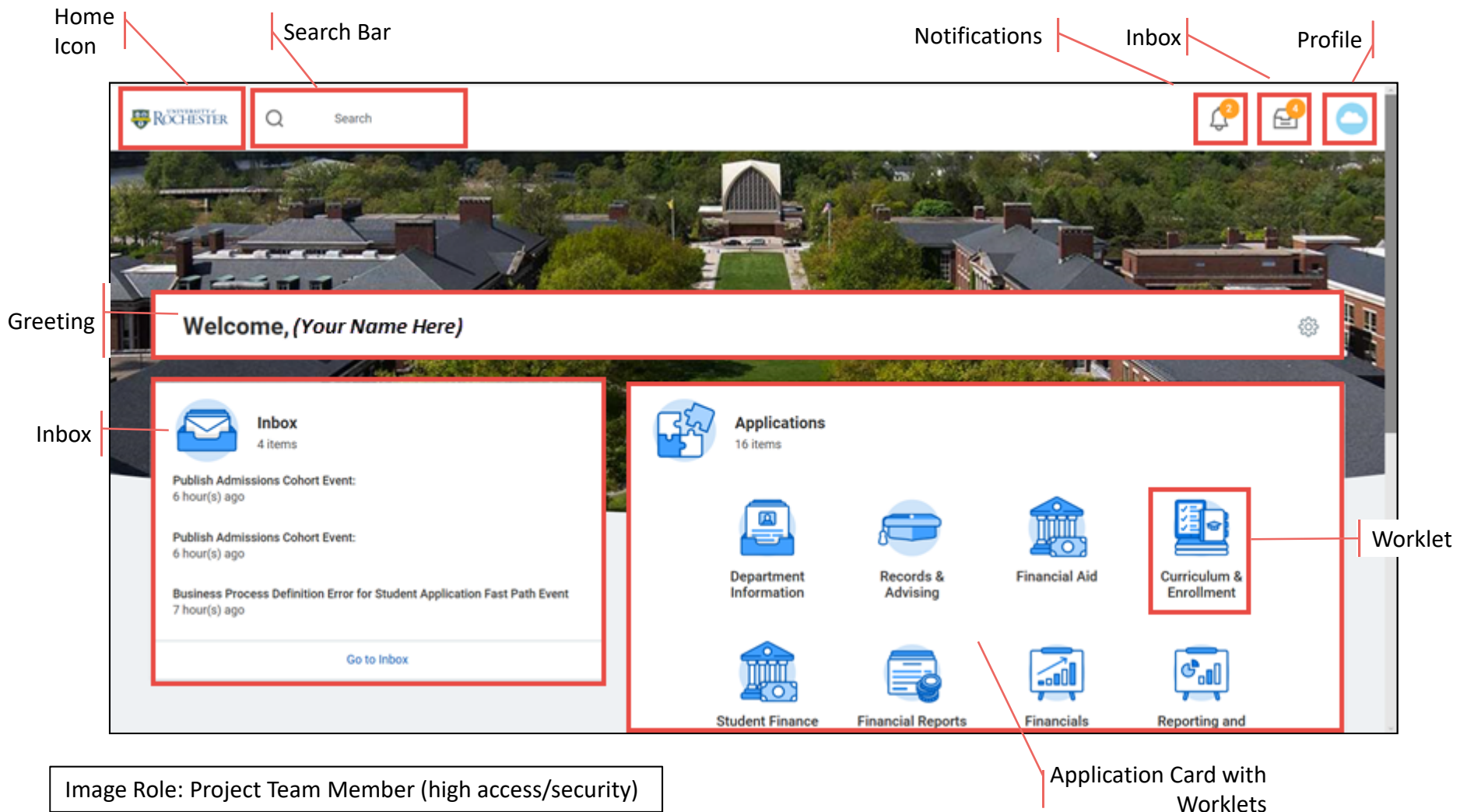

Image Role: Project Team Member (high access/security)

Application Card with Worklets

# UR Student - Student Profile

Navigation for a student record

Dashboard Cards

The screenshot shows the UR Student profile page for Julia Smith. The page is divided into three main sections: a navigation sidebar on the left, an Academic Progress section, and a Student Information section. The navigation sidebar is blue and contains a profile picture, name, and several menu items. The Academic Progress section shows a 40% completion rate for the Mechanical Engineering B.S. Undergraduate Major, with 2 of 5 requirements satisfied. The Student Information section lists the student's ID, academic level, class standing, academic unit, and program of study.

Field	Value
Student ID	STU001110
Academic Level	Undergraduate
Class Standing	Second Year
Academic Unit	Hajim School of Engineering & Applied Sciences
Program of Study	Mechanical Engineering B.S. Undergraduate Major

Image Role: Project Team Member (high access/security)

# UR Student - Mobile Student View

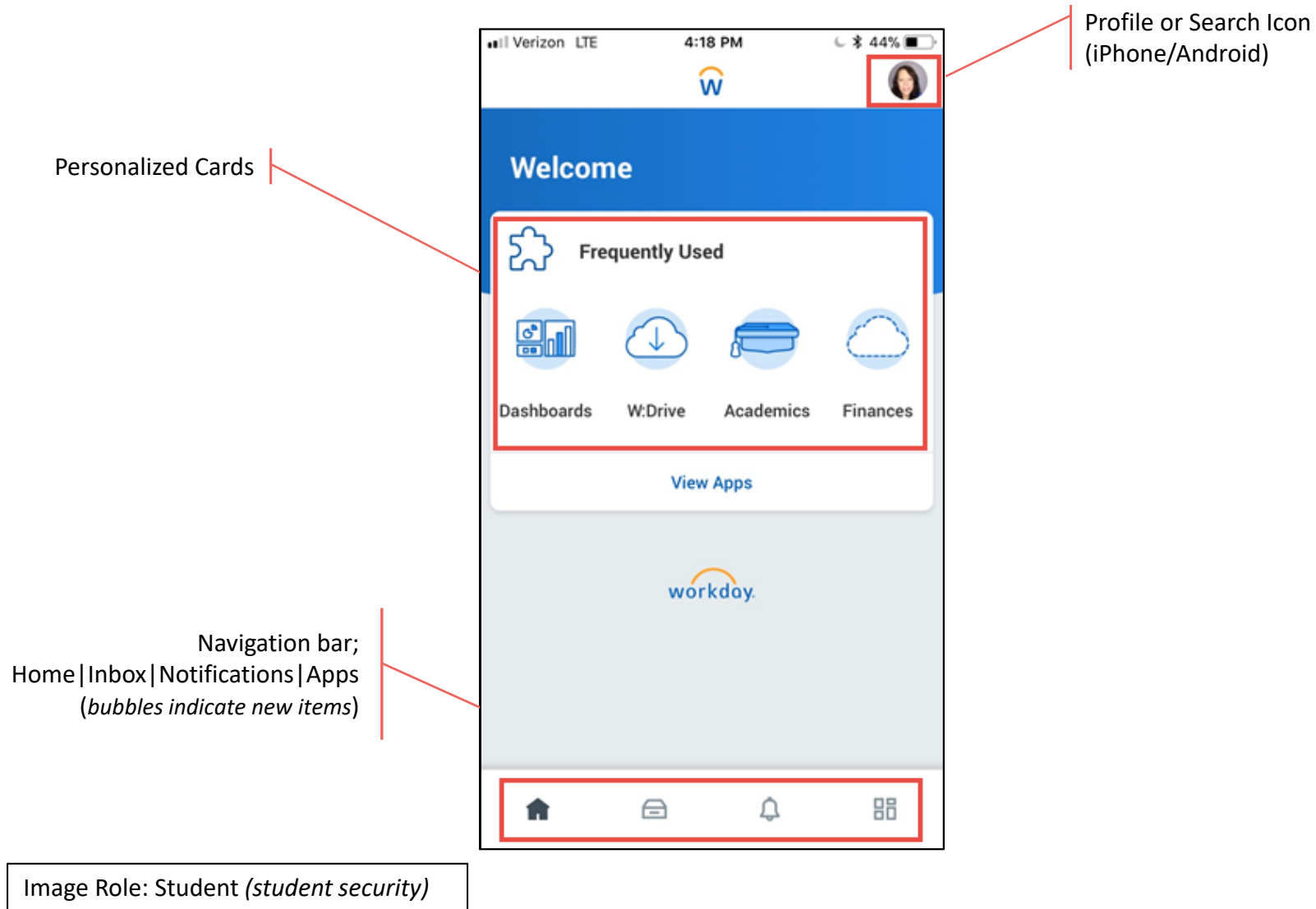





UNIVERSITY *of* ROCHESTER



UR Student